

COPPER SINGLE HOLE HEAVY DUTY SERIES

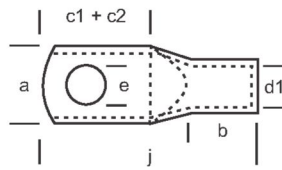

File No.: E328465

CAT NO:	WIRE	STUD	d1	j	a	c1 + c2	b	e	MARKING INFO	TOOL & DIE REFERENCE	NO. OF CRIMPS	STRIP LENGTH
CE 801HD	8	1/4	4.70	28.50	11.99	14.00	10.01	6.40	8 MH14-RED	M=MH-14	1	8mm
CE 802HD	8	5/16	4.70	35.00	15.01	20.00	10.01	8.40	8 MH14-RED			8mm
CE 803HD	8	3/8	4.70	38.99	16.99	24.00	10.01	10.50	8 MH14-RED			8mm
CE 804HD	8	1/2	4.70	42.01	19.00	26.01	10.01	13.00	8 MH14-RED			8mm
CE 811HD	6	1/4	5.41	33.25	11.99	13.74	13.00	6.40	6 UL851-BU			11mm
CE 812HD	6	5/16	5.41	37.49	15.01	18.03	13.00	8.40	6 UL851-BU	I=ECO50 DIE.UL851	1	11mm
CE 813HD	6	3/8	5.41	41.50	16.99	22.00	13.00	10.50	6 UL851-BU			11mm
CE 814HD	6	1/2	5.41	44.98	19.00	24.99	13.00	13.00	6 UL851-BU			11mm
CE 821HD	4	1/4	6.96	37.49	14.00	15.01	15.01	6.40	4 UL100-GREY		1	14mm
CE 822HD	4	5/16	6.96	42.01	18.00	20.00	15.01	8.40	4 UL100-GREY	I=ECO50 DIE.UL100		14mm
CE 823HD	4	3/8	6.96	46.00	18.00	23.98	15.01	10.50	4 UL100-GREY			14mm
CE 824HD	4	1/2	6.96	48.01	19.00	26.01	15.01	13.00	4 UL100-GREY			14mm
CE 831HD	1-2	1/4	9.88	47.02	20.00	20.00	20.00	6.40	1UL140-PINK			18mm
CE 832HD	1-2	5/16	9.88	47.02	20.00	20.00	20.00	8.40	1UL140-PINK	I=ECO50 DIE UL140	1	18mm
CE 833HD	1-2	3/8	9.88	51.00	19.99	24.00	20.00	10.50	1UL140-PINK			18mm
CE 834HD	1-2	1/2	9.88	56.01	23.01	26.01	20.00	13.00	1UL140-PINK			18mm
CE 851HD	1/0	1/4	11.38	50.01	22.00	20.00	20.00	6.40	1/0 UL155-BLK	I=ECO50 DIE UL155		18mm
CE 852HD	1/0	5/16	11.38	50.01	22.00	20.00	20.00	8.40	1/0 UL155-BLK		1	18mm
CE 853HD	1/0	3/8	11.38	54.00	22.00	24.00	20.00	10.50	1/0 UL155-BLK			18mm
CE 854HD	1/0	1/2	11.38	58.01	23.01	26.01	20.00	13.00	1/0 UL155-BLK			18mm
CE 862HD	2/0	5/16	11.94	52.40	23.01	20.00	21.01	8.40	2/0 UL165-ORG			20mm
CE 863HD	2/0	3/8	11.94	55.01	23.01	24.00	21.01	10.50	2/0 UL165-ORG	I=ECO50 DIE UL165	1	20mm
CE 864HD	2/0	1/2	11.94	59.00	23.01	26.01	21.01	13.00	2/0 UL165-ORG			20mm
CE 873HD	3/0	3/8	13.39	59.99	26.01	24.00	24.99	10.50	3/0 UL180-PUR			23mm
CE 874HD	3/0	1/2	13.39	62.00	26.01	26.01	24.99	13.00	3/0 UL180-PUR	I=ECO50 DIE UL180	2	23mm
CE 883HD	4/0	3/8	15.06	65.00	27.99	27.99	26.01	10.50	4/0 UL195-YEL			24mm
CE 884HD	4/0	1/2	15.06	65.00	27.99	27.99	26.01	13.00	4/0 UL195-YEL	I=ECO50 DIE UL195	2	24mm

Terminals can be provided with or without inspection vents.